

EUROPLUS

Dual function pressure balance trim with control module

MODEL # 19881000

Pure Freude
an Wasser

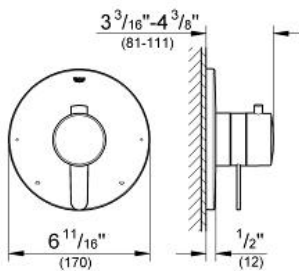

ADA

C

Product Description:

EUROPLUS

Dual function pressure balance trim with control module

Standard Specification:

- For shower/tubs with non-diverter tub spout or for 2 shower outlet applications
- Integrated volume control
- 2-way diverter function
- 1 axis operation
- Requires GrohFlex universal rough-in box (35 026 000) (sold separately)
- **GROHE SilkMove**
- 5.3 gpm at 45 psi (bottom outlet)
- 2.9 gpm at 45 psi (top outlet)
- ABS trim plate
- **GROHE StarLight** chrome finish

Applicable Codes & Standards:

- Energy Policy Act of 1992
- ASME A112.18.1/CSA B125.1
- ICC/ANSI A117.1

Color:

- 19881000 StarLight Chrome

